

DISCLOSURE PLAN

FOR PROPOSED LOT 730

Proposed Lot 730 is currently described as part of Lot 4 on SP146972 situated in Felling Drive, Maudsland

LEGEND

- DESIGN FILL CONTOUR (0.5m INTERVAL)
- DESIGN F.S.L. SURFACE LEVEL CONTOUR (0.5m INTERVAL)
- AREA OF FILL
- FOR RETAINING WALL CONSTRUCTION DETAIL SEE ENGINEERING CIVIL O.P.W. PLANS

Builders Note:

Builders shall not build off the design levels shown; a site survey is required. This note is an integral part of this plan.

Engineering Note:

Engineering design information supplied by Burchills Engineering Solutions, September 2018.

Compaction Statement:

All compaction testing under this contract is to be carried out to AS3798 Level 1 Standard by a NATA-Accredited Testing Authority. Certification for all earthworks construction and testing is to be provided by a registered professional Engineer Queensland (RPEQ) engaged by the contractor.



ORCHARD Property Group	
Local Authority : Gold Coast City	
Height Datum : AHD	
Height Origin: PM115678 RL 51-641	
Contour Interval : 0.5 m	
ENG :	
134207-Felling Dr\Disclosure Info\St 7	
BODY : 134207-Bdy-2018-09-28	
Surveyor: RPS GC	
Drawn : BJB	
Scale : 1:200 @ A3	
Date: 28 SEPTEMBER 2018	
Dwg No: 134207-DISC-10/730	

RPS Australia East Pty Ltd
ACN 140 292 762
ABN 44 140 292 762
Lakeside Corporate Space, Suite 425, Level 2
Building 4, 34-36 Glenferrie Drive,
Robina PO Box 1048 Robina DC, Qld 4226
T +61 7 555 36900
F +61 7 555 36999
W ipsgroup.com.au

© COPYRIGHT PROTECTING PLAN
Unauthorized reproduction or amendment
not permitted. Please contact the author.

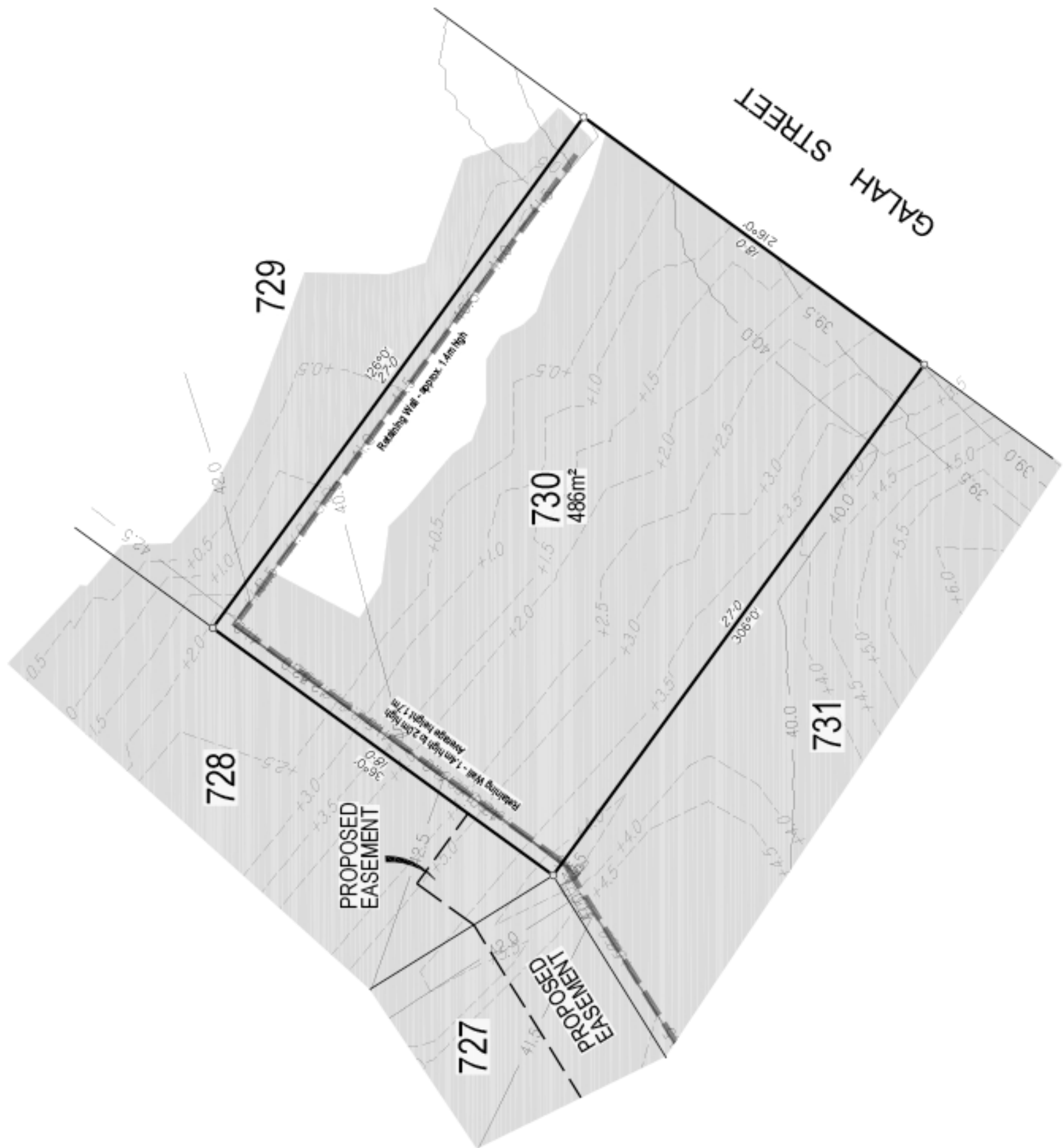

Note:
This plan has been prepared by RPS Australia East Pty Ltd (ACN 140 292 762), which is registered with the Surveyors Board of Queensland as a Cadastral Surveyor.